



## SSCXN Series - Stainless Steel



The SSCXN Series Centrifugal Pumps feature high-head performance and quiet operation. These pumps are remarkably versatile and have corrosion-resistant dependability.

### APPLICATIONS

Ideal choice for a wide range of pump applications and varying temperature conditions

### SPECIFICATIONS

**Pump Body** – Stainless steel

**Impeller** – Noryl<sup>®</sup>

**Multiple Seal Options**

### FEATURES

**Stainless Steel Housing and Shaft –**

Maximum corrosion resistance in chemical as well as water applications; smooth flow path assures quiet operation.

**High Temperature Rating –** The SSCXN Series centrifugal pumps are designed for temperatures up to 185°F.

**Mechanical Shaft Seal –** Precision lapped and highly polished carbon-ceramic, stainless steel construction with buna elastomers; delivers long-life reliability.

**Multiple Seal Options –** Choice of three seal options to meet a wide variety of pump applications.

- The standard seal in a SSCX Series is a Buna carbon/ceramic. The volute uses a Buna O-ring to seal the pumping chamber sections.
- Viton with carbon/ceramic faces, includes Viton O-ring change out in pump volute.
- Viton with carbon/silicon carbide faces, includes Viton O-ring change out in pump volute.

**Noryl<sup>®</sup> Composite Impeller –** Precision molded for perfect balance and lasting quality; ultra-smooth flow ports maximize performance and efficiency. 304SS impeller insert for increased durability.

**Drain/Vent Ports –** Priming and draining is easier, faster.

**Max. Operating Pressure –** 125 PSI

# BERKELEY® SSCXN Series - Stainless Steel

## ORDERING INFORMATION

MODEL NUMBER	CATALOG NUMBER	HP	SUCTION	DISCHARGE	MOTOR VOLTAGE	PHASE	ENCLOSURE	APPROX. WT. LBS.
SS1XN-1/2	B78635	1/2	1-1/4"	1"	115/230	1	ODP	29
	B78636				230/460	3	ODP	29
	B78647				115/230	1	TEFC	32
	B78648				230/460	3	TEFC	32
SS1XN-3/4	B78637	3/4	1-1/4"	1"	115/230	1	ODP	38
	B78638				230/460	3	ODP	38
	B78649				115/230	1	TEFC	41
	B78650				230/460	3	TEFC	41
SS1XN-1	B78639	1	1-1/4"	1"	115/230	1	ODP	47
	B78640				230/460	3	ODP	47
	B78651				115/230	1	TEFC	50
	B78652				230/460	3	TEFC	50
SS1XN-1-1/2	B78641	1-1/2	1-1/4"	1"	115/230	1	ODP	62
	B78642				230/460	3	ODP	62
	B78653				115/230	1	TEFC	65
	B78654				230/460	3	TEFC	65
SS1-1/4XN-2	B78643	2	1-1/2"	1-1/4"	230	1	ODP	77
	B78644				230/460	3	ODP	77
SS1-1/4XN-2-1/2	B78645	2-1/2	1-1/2"	1-1/4"	230	1	ODP	90
	B78646				230/460	3	ODP	90

## PUMP PERFORMANCE

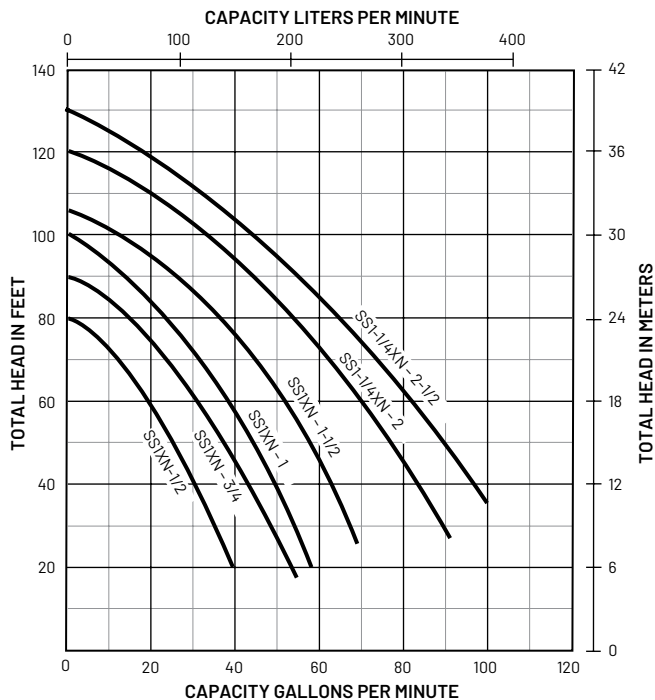

# BERKELEY® SSCXN Series - Stainless Steel

## OUTLINE DIMENSIONS

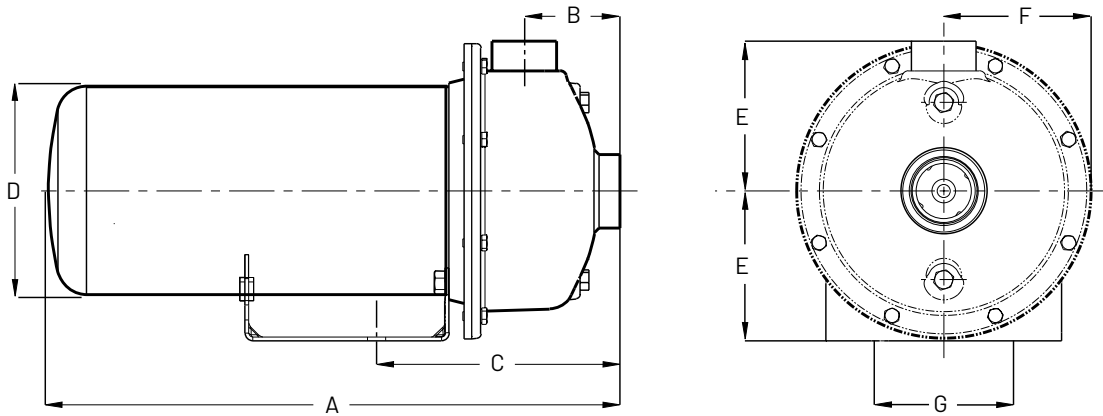

Dimensions (in inches) are for estimating purposes only.

## DIMENSIONS IN INCHES - SSCXN OPD

HP	NPT Suct.	NPT Disch.	A (1 phase)	A (3 phase)	B	C	D	E	F	G
1/2	1-1/4	1	13.2	13.5	2.43	6.51	5.63	4.13	4.06	4.875
3/4	1-1/4	1	13.2	13.5	2.43	6.51	5.63	4.13	4.06	4.875
1	1-1/4	1	14.2	14.0	2.43	6.51	5.63	4.13	4.06	4.875
1-1/2	1-1/4	1	14.5	14.5	2.43	6.51	5.63	4.13	4.06	4.875
2	1-1/2	1-1/4	16.0	15.7	2.63	6.71	5.63	4.13	4.06	4.875
2-1/2	1-1/2	1-1/4	16.9	16.4	2.63	6.71	5.63	4.13	4.06	4.875

## DIMENSIONS IN INCHES - SSCXN TEFC

HP	NPT Suct.	NPT Disch.	A (1 phase)	A (3 phase)	B	C	D	E	F	G
1/2	1-1/4	1	14.0	14.2	2.43	6.51	6.44	4.13	4.06	4.875
3/4	1-1/4	1	14.9	14.2	2.43	6.51	6.44	4.13	4.06	4.875
1	1-1/4	1	15.7	15.2	2.43	6.51	6.44	4.13	4.06	4.875
1-1/2	1-1/4	1	16.2	15.2	2.43	6.51	6.44	4.13	4.06	4.875



**293 Wright Street  
Delavan, WI 53115  
USA  
Ph: 888-782-7483  
Orders Fax: 800-426-9446**

**490 Pinebush Road  
Unit 4, Cambridge  
Ontario N1T 0A5  
Canada  
Ph: 800-363-7867  
Orders Fax: 888-606-5484**

**[www.BerkeleyPumps.com](http://www.BerkeleyPumps.com)**

Because we are continuously improving our products and services, Pentair reserves the right to change specifications without prior notice.

CB2051WS (07/02/18) ©2018 Pentair plc. All Rights Reserved.